

PROJ: LPS\_Standards.dwg  
 PEN: ..\..\..\..\pen\BW\_PENTABLE.tbl  
 USER: slocaw  
 DATE: 2/16/2017  
 DGN: ..\STANDARD\2017\LSPs\lsp60.dgn

<b>LINCOLN</b> PUBLIC WORKS AND UTILITIES	PROJECT NO.	SHEET NO.
	LSP 60	1
	Date: 2/17/2017	Drawn: CAW
	Horz. Scale:	Checked: Approved:

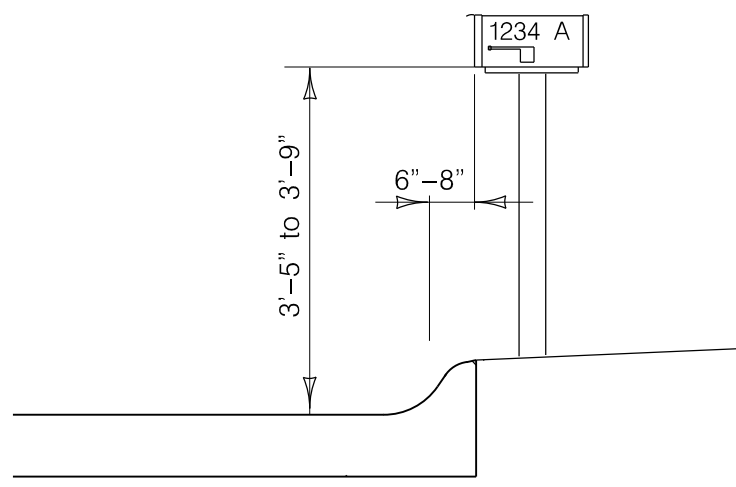

GROUPING OF TWO OR MORE MAIL BOXES TOGETHER IS ENCOURAGED.  
 THE ADDRESS SHOULD BE EITHER ON THE MAIL BOX DOOR OR ON THE SIDE OF THE MAILBOX. PLACING A NAME ON THE BOX IS OPTIONAL.

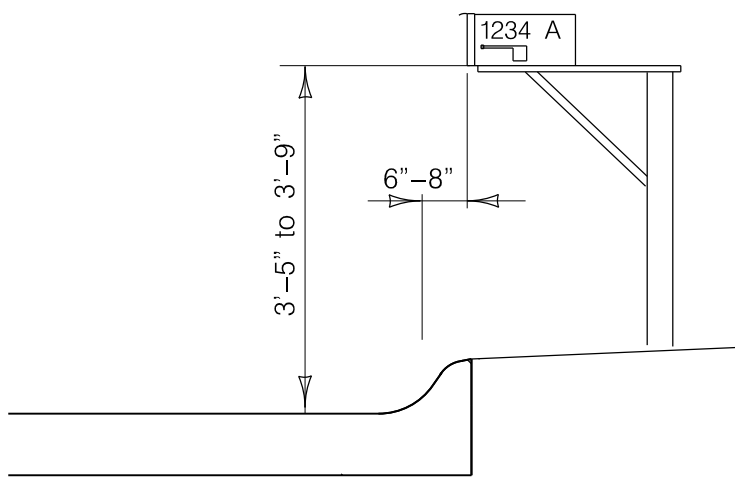
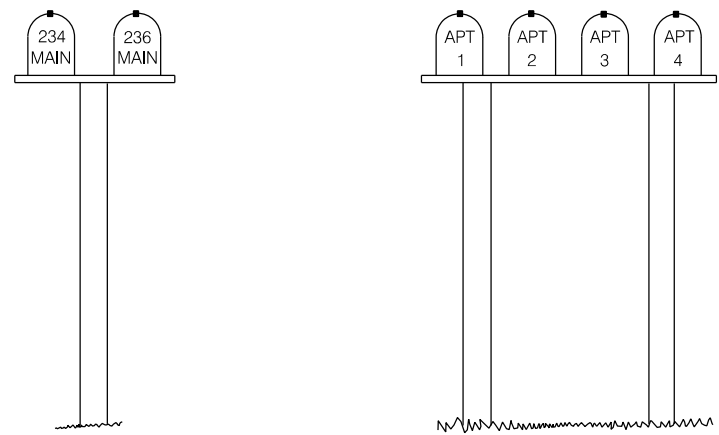

**MAILBOX GROUPING**

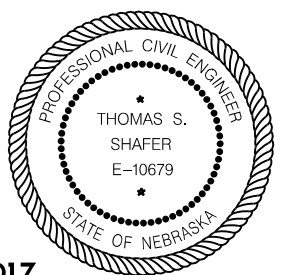

**EFFECTIVE DATE MARCH 22, 2017**

**MAIL BOX INSTALLATIONS**

This document was originally issued and sealed by Thomas S. Shafer, E-10679, on 2-17-2017. This media should not be considered a certified document.