

PROJ: LPS_Standards.dwg
 PEN: \\nables\pen\BW_PENTABLE.tbl
 USER: slocaw
 DATE: 2/17/2017
 DGN: ...2017\LSPs\lsp660s1.dgn

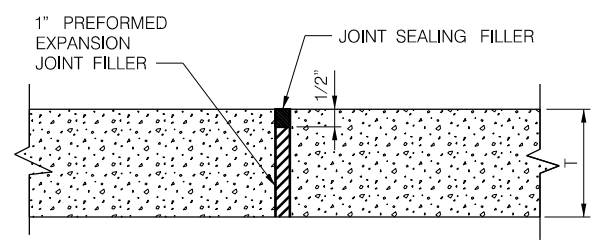

TO BE USED AT THE END OF RETURN ON THE NON THROUGH LEG OF A T-INTERSECTION AND AS PER ENGINEER AT THE END OF CURVES

EXPANSION JOINT

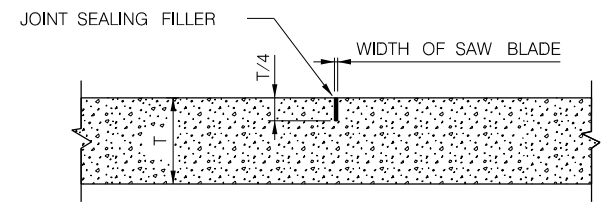

NOTE: CONTRACTION JOINTS SHALL BE SAWED. CONTRACTION JOINTS SHALL BE PLACED AT NOT MORE THAN 15' INTERVALS.

CONTRACTION JOINT

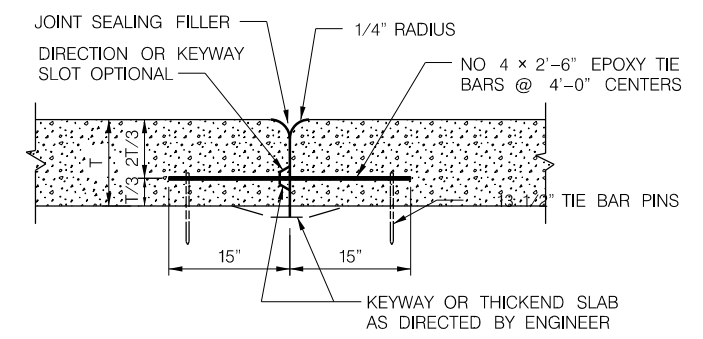

TRANSVERSE CONSTRUCTION JOINT

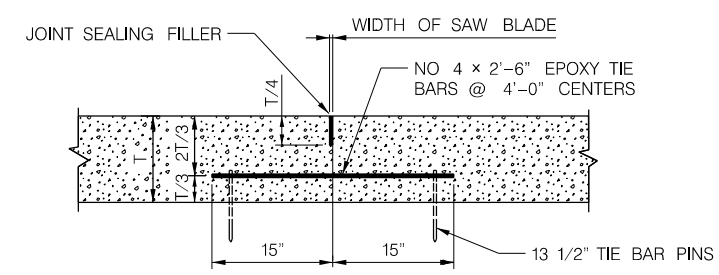

WHEN TWO ADJACENT LANES ARE POURED AT THE SAME TIME, THE LONGITUDINAL JOINT COMMON TO THE TWO LANES SHALL BE SAWED.

SAWED

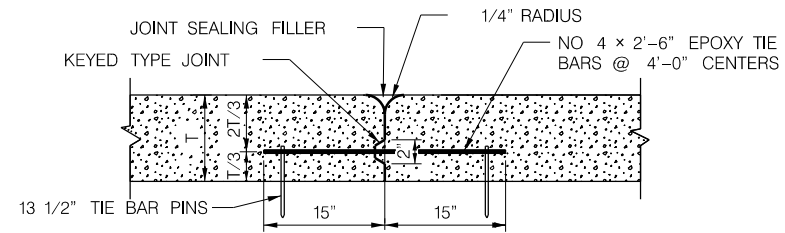

KEY TYPE JOINT SHALL BE USED ON ALL LONGITUDINAL CONSTRUCTION JOINTS WHEN THE ADJACENT LANE IS NOT POURED AT THE SAME TIME.

KEY TYPE

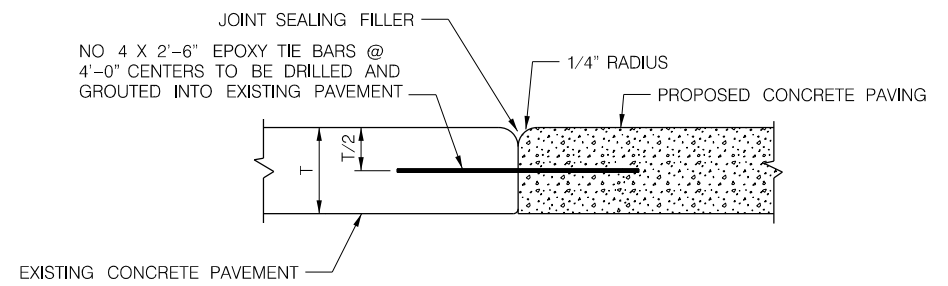

PROPOSED TO EXISTING PAVEMENT

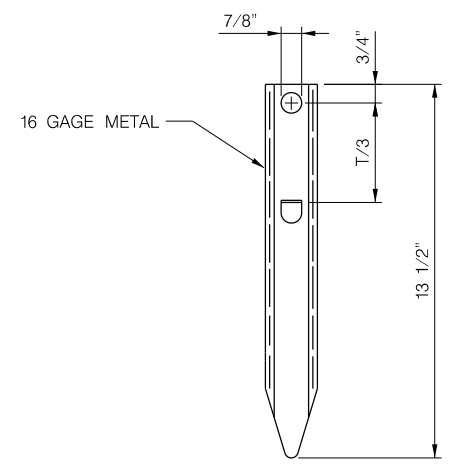
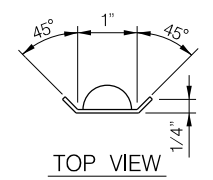

TIE BAR PIN

NOTE:
 THE CONTRACTOR MAY SUBSTITUTE OTHER DESIGNS FOR EXPANSION AND CONTRACTION JOINT SUPPORTS IN LIEU OF THE TYPE SHOWN WITH PRIOR WRITTEN APPROVAL BY THE ENGINEER.

ALL JOINTS SHALL BE SEALED WITH JOINT SEALING FILLER (HOT POURED TYPE) AS PER STANDARD SPECIFICATIONS.
 TIE BARS SHALL BE EPOXY COATED DEFORMED BARS.

ALL BARS SHALL SATISFY THE BEND TEST REQUIREMENTS FOR STRUCTURAL GRADE BILLET STEEL IN ACCORDANCE WITH THE SPECIFICATIONS.

THE CONTRACTOR MAY USE A MACHINE FOR PLACING THE LONGITUDINAL TIE BARS IN LIEU OF THE TIE BAR PINS, IF A MECHANICAL TIE BAR PLACEMENT MACHINE IS NOT USED, TIE BAR PINS AS SHOWN WILL BE USED.

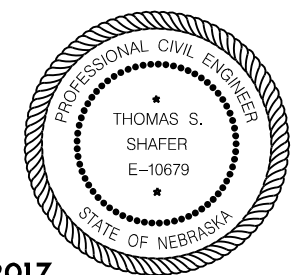

EFFECTIVE DATE MARCH 22, 2017
CONCRETE PAVEMENT JOINT DETAILS

This document was originally issued and sealed by Thomas S. Shafer, E-10679, on 2-17-2017. This media should not be considered a certified document.

PROJ: LPS_Standards.dwg
 PEN: ..\ables\pen\BW_PENTABLE.tbl
 USER: slocaw
 DATE: 2/17/2017
 DGN: ..\2017\LSPs\lsp660s2.dgn

LINCOLN PUBLIC WORKS AND UTILITIES	PROJECT NO.	SHEET NO.
	LSP 660	2
Date: 2/17/2017	Drawn: CAW	
Horz. Scale: NONE	Checked:	Approved:

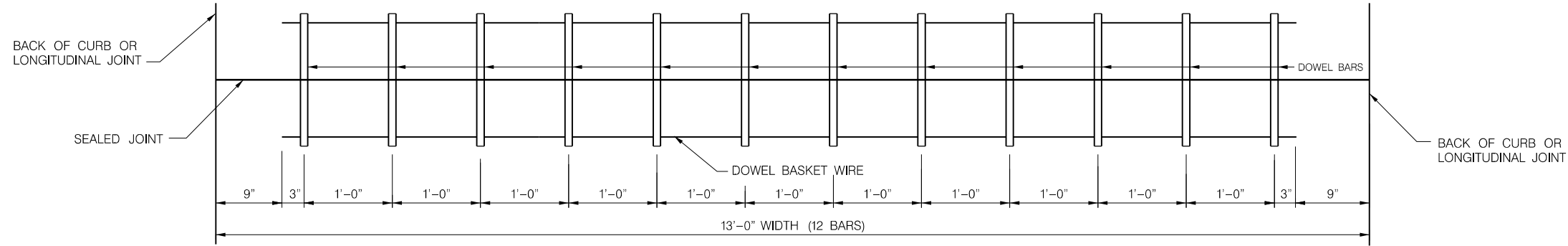

ASSEMBLY PLAN

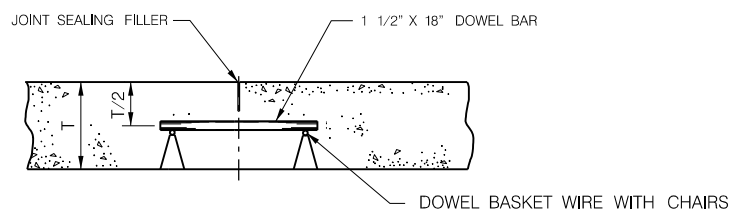

CONTRACTION JOINT

NOTES:
 THE CONTRACTOR MAY SUBSTITUTE OTHER DESIGNS FOR EXPANSION AND CONTRACTION JOINT SUPPORTS IN LIEU OF THE TYPE SHOWN WITH PRIOR WRITTEN APPROVAL BY THE ENGINEER.
 DOWEL BARS SHALL BE EPOXY COATED AND A MINIMUM OF 18" IN LENGTH.
 TIE BARS SHALL BE DEFORMED BARS AND ALL OTHERS SHALL BE SMOOTH.
 FOR LOAD TRANSFER DEVICES IN LANES OTHER THAN THE 13' LANES SHOWN, MAINTAIN THE SPACING OF THE 18" DOWEL BARS AT 1' INTERVALS.
 THE ENDS OF THE DOWEL BASKET WIRE SHALL NOT BE LESS THAN 3" FROM THE EDGES OF THE PAVEMENT OR THE LONGITUDINAL JOINT.
 KEY TYPE LONGITUDINAL JOINTS AND TRANSVERSE CONSTRUCTION JOINTS SHALL BE EDGED WITH 1/4" RADIUS AT TIME OF CONCRETE PLACEMENT.
 EXPANSION JOINTS SHALL NOT BE SKEWED.
 T = PAVEMENT THICKNESS

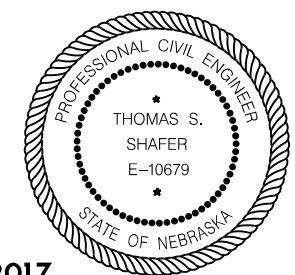

EFFECTIVE DATE MARCH 22, 2017
CONCRETE PAVEMENT JOINT DETAILS

This document was originally issued and sealed by Thomas S. Shafer, E-10679, on 2-17-2017. This media should not be considered a certified document.