

USER: e:\pmpo
 DATE: Wednesday, March 17, 2004
 DGN: ... \DESIGN\SHEETS\1234569.dgn

APPROVED LOCATION FOR
 CONSULTANT LOGO AND
 PROJ. NO.



CITY PROJECT NO.	SHEET NO.
700000	1
Date: 03-19-04	Drawn: ABC
	Checked: DEF
	Approved: GHI

CITY OF LINCOLN, NE (2003)

84TH ST. FROM MONTELLO RD TO KATHY LN. & PIONEERS BLVD. FROM PAGODA LN. TO 86TH ST. WIDENING PROJECT #700000

SHT NO.	SHEET INDEX
1	COVER
2	SUMMARY OF QUANTITIES
3-4	TYPICAL SECTIONS
5-6	GENERAL NOTES
7	DETAILS
8-9	HORIZONTAL CONTROL
10-24	GEOMETRICS
25-54	CONSTRUCTION PHASING
55-69	TRAFFIC CONTROL
70-84	SEDIMENT AND EROSION CONTROL
85-99	JOINTS AND GRADES
100-114	ROADWAY PLAN AND PROFILE
115-129	CONSTRUCTION AND REMOVAL
130-134	RETAINING WALL PLAN AND PROFILE
135-136	RETAINING WALL DETAILS
137-138	STORM DRAINAGE PLAN AND PROFILE
139-148	CULVERT/CHANNEL CROSS SECTIONS
149-163	WASTE WATER PLAN AND PROFILE
164-178	WATER MAIN PLAN AND PROFILE
179-195	TRAFFIC SIGNAL AND LIGHTING
196-210	PAVEMENT MARKING AND SIGNING
211-225	LANDSCAPING PLAN
227-255	RIGHT-OF-WAY
XS 1-50	ROADWAY CROSS SECTIONS

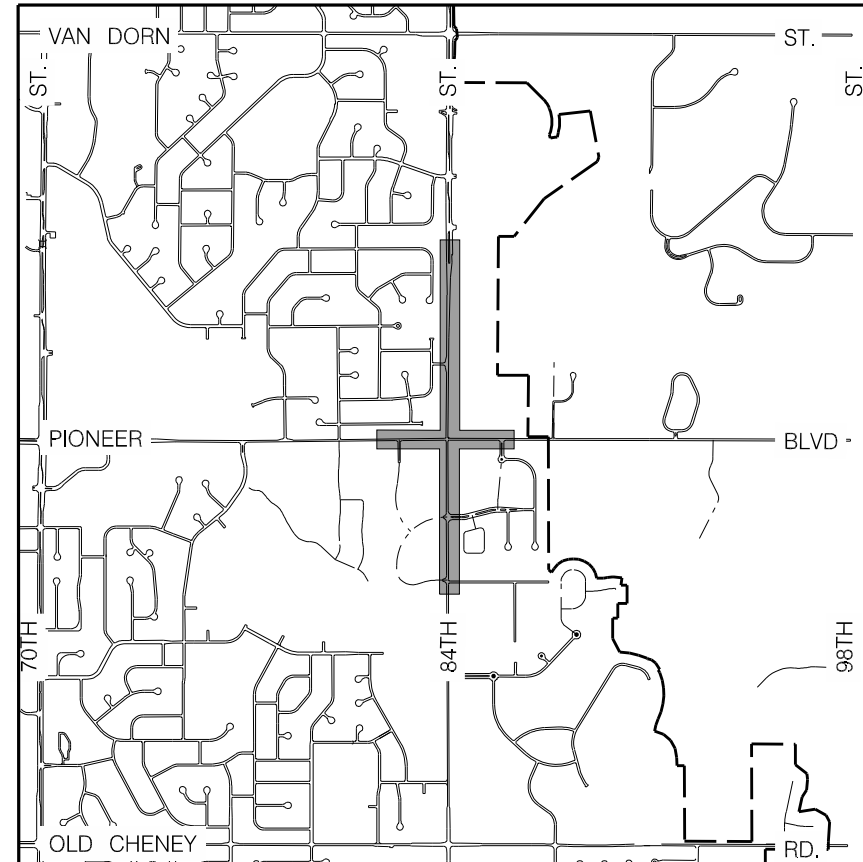

PROJECT CONTACT

ENGINEERING SERVICES:
 DEVELOPMENT SERVICES
 531 WESTGATE BLVD.
 LINCOLN, NE 68528
 ATTN: DENNIS BARTELS...441-7595

UNL PHYSICAL PLANT
 ATTN: CLARKE DEVRIES
 17TH & 'Y' STS.
 LINCOLN, NE 68588
 ATTN: CLARKE DEVRIES...472-3131

SPRINT COMMUNICATIONS
 SUPERVISOR, TRANSMISSION OPERATIONS
 5810 'F' STREET
 OMAHA, NE 68117
 ATTN: JEFF HUMMEL... (402) 522-2662

ENGINEERING SERVICES:
 TRAFFIC OPERATIONS
 531 WESTGATE BLVD.
 LINCOLN, NE 68528
 ATTN: SCOTT OFFER...441-7851

ALLTEL
 401 S. 21ST ST.
 LINCOLN, NE 68510
 ATTN: JIM BARTLES

TIME WARNER CABLE
 5400 SO. 16TH ST.
 LINCOLN, NE 68512
 ATTN: LOU KIPPER...421-0393

PARKS DEPARTMENT
 2740 'A' ST.
 LINCOLN, NE 68502
 ATTN: MARK CANNEY...441-8248

AQUILA
 1600 WINDHOEK DR.
 LINCOLN, NE 68512
 ATTN: PAT BARTEK...437-1787

QWEST COMMUNICATIONS
 ATTN: FRANCIS BUSQUE
 13952 DENVER W. PKWY, BLDG 53 #200
 GOLDEN, CO 80401
 ATTN: FRANCIS BUSQUE... (303) 445-7066

LANCASTER RURAL WATER DISTRICT NO. 1
 310 FIR
 BENNETT, NE 68317
 ATTN: KEN HALVERSON...782-3495

LINCOLN ELECTRIC SYSTEM
 P.O. BOX 80869
 LINCOLN, NE 68501
 ATTN: MELODY KNAPP...467-7636

WILLIAMS PIPELINE CO.
 P.O. BOX 100
 GREENWOOD, NE 68366
 ATTN: DONNY JOHNSON...789-3350



PRIOR TO CONSTRUCTION:

CALL : 1-800-331-5666 FOR LOCATION OF UNDERGROUND TELEPHONE, ELECTRIC, GAS MAINS, CABLEVISION AND CITY OF LINCOLN UTILITIES.

NOTE: EXISTING UNDERGROUND AND OVERHEAD UTILITIES AND DRAINAGE STRUCTURES HAVE BEEN PLOTTED FROM AVAILABLE INFORMATION AND THEREFORE, THEIR LOCATIONS MUST BE CONSIDERED APPROXIMATE ONLY. IT IS THE RESPONSIBILITY OF THE INDIVIDUAL CONTRACTORS TO EXACTLY LOCATE AND PROTECT EACH EXISTING UTILITY BEFORE AND DURING ACTUAL CONSTRUCTION.



APPROVED FOR CONSTRUCTION

CITY ENGINEER'S OFFICE

DATE

COVER

123-4-56

123-4-56