

APPROVED LOCATION FOR CONSULTANT LOGO AND PROJ. NO.

CITY PROJECT NO.	700000	SHEET NO.	137
Date:	03-19-04	Drawn:	ABC
Horz. Scale:	1 : 40	Checked:	DEF
		Approved:	GHI

CITY OF LINCOLN
NEBRASKA

REMOVE EXISTING R.C. FLARED END SECTION

STATION	SIDE	SIZE	EACH
768+48.00	25' RT.	30"	1
769+95.00	42' LT.	48"	1

REMOVE EXISTING STORM SEWER PIPE

STATION TO STATION	SIDE	SIZE	LIN. FT.
768+50.00 - 770+08.00	25' RT.	30"	158.0
769+08.00 - 769+27.00	102' RT. - 25' RT.	15"	80.0
770+08.00 - 770+11.00	8' RT. - 22' RT.	48"	15.0

REMOVE EXISTING SANITARY SEWER MANHOLE, (COMPLETE)

STATION	SIDE	EACH
769+05.20	56' RT.	1

ADJUST MANHOLE TO GRADE

NO.	STATION	SIDE	RIM ELEV.
1	769+27.00	40' LT.	1327.35

REMOVE EXISTING GRATE INLET (COMPLETE)

STATION	SIDE	EACH
770+10.50	25' RT.	1

STORM SEWER CURVE DATA

C7	P.C. STA. 769+81.97, 12.96' RT. Δ = 20° 05' 48" R = 75.00 T = 13.29 L = 26.31 P.T. STA. 770+07.67, 7.83' RT.	C8A	P.C. STA. 101+33.82, 26.71' LT. Δ = 10° 26' 22" R = 389.75 T = 35.61 L = 71.02 P.R.C. STA. 101+95.91, 36.18' LT.
C71	P.C. STA. 769+82.64, 87.17' RT. Δ = 24° 22' 39" R = 100.00 T = 21.60 L = 42.55 P.T. STA. 769+90.67, 45.70' RT.	C8B	P.R.C. STA. 101+95.91, 36.18' LT. Δ = 9° 41' 28" R = 389.75 T = 33.04 L = 65.92 P.T. STA. 102+60.18, 53.37' LT.
C81	P.C. STA. 769+60.36, 52.81' LT. Δ = 8° 41' 44" R = 100.00 T = 7.60 L = 15.17 P.T. STA. 769+75.09, 55.93' LT.		

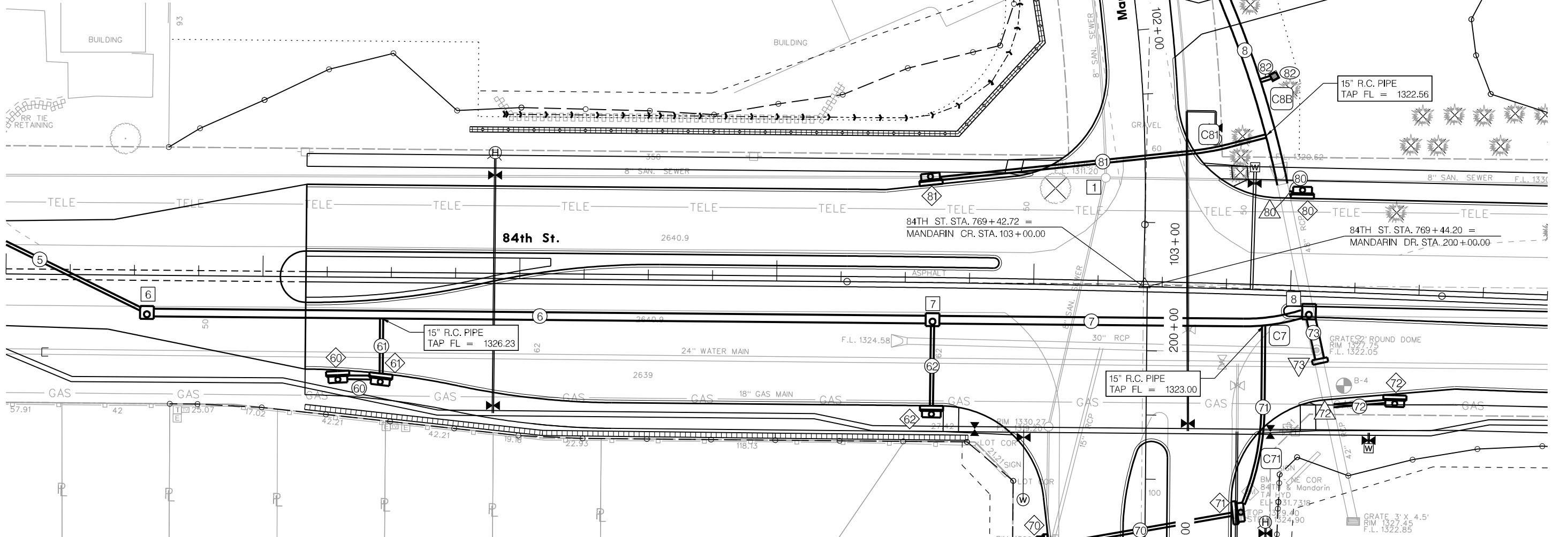

BUILD GRATE INLET

NO.	STATION	SIDE	TYPE	RIM ELEV.	F.L.
82	769+91.30	83.32' LT.	F-2	1324.25	15" = 1320.75

TAP EXISTING STORM SEWER PIPE

NO.	STATION	SIDE	F.L.
72	770+16.60	44.43' RT.	15" = 1323.38 42" = 1322.25
80	769+96.37	38.06' LT.	15" = 1322.15 48" = 1320.40

BUILD REINFORCED CONCRETE SEWER PIPE

NO.	SIZE	LIN. FT.	DESCRIPTION
5	15"	120	CANTED INLET PROJ. 700777 to MH 6
6	36"	318	MH 6 to MH 7
60	15"	11	INLET 60 to INLET 61
61	15"	23	INLET 61 to TAP PROP. 36" R.C.P.
62	15"	32	INLET 62 to MH 7
7	36"	145	MH 7 to MH 8
70	15"	75	INLET 70 to INLET 71
71	15"	66	INLET 71 to TAP PROP. 36" R.C.P.
72	15"	21	INLET 72 to TAP 72
73	42"	14	PROP R.C. COLLAR to MH 8
8	48"	139	EXIST. 48" R.C.P. STA. 14+60.87, 53.5' LT. to MH 9
80	15"	5	INLET 80 to TAP 80
81	15"	130	INLET 81 to TAP PROP. 48" R.C.P.
82	15"	7	GRATE INLET 82 to TAP PROP. 48" R.C.P.

BUILD CURB INLET

NO.	STATION	SIDE	TYPE	RIM ELEV.	F.L.
60	766+29.78	38.91' RT.	CANTED	1330.95	15" = 1327.55
61	766+46.66	39.53' RT.	STRAIGHT	1330.55	15" = 1327.38
62	768+61.07	50.08' RT.	STRAIGHT	1327.57	15" = 1324.32
70	769+05.45	102.8' RT.	CANTED	1329.27	15" = 1326.00
71	769+81.96	87.2' RT.	CANTED	1328.80	15" = 1325.25
72	770+42.14	41.41' RT.	CANTED	1329.39	15" = 1326.14
80	770+03.24	38.69' LT.	STRAIGHT	1328.80	15" = 1325.50
81	768+59.50	40.16' LT.	STRAIGHT	1327.86	15" = 1324.64

BUILD STORM SEWER MANHOLE

NO.	STATION	RIM ELEV.	F.L.
6	765+55.00, 14.52' RT.	1333.10	15" = 1328.92 36" = 1327.17
7	768+60.81, 14.40' RT.	1328.00	15" = 1323.96 36" = 1323.30
8	770+07.50, 7.90' RT.	1329.65	36" = 1322.20 42" = 1321.70 48" = 1321.20
9	101+31.15, 27.03' LT.	1324.20	48" = 1316.00

BUILD CONCRETE COLLAR

NO.	STATION	SIDE	DESC.
73	770+12.43	27.00' RT.	42" - SEE LSP 150

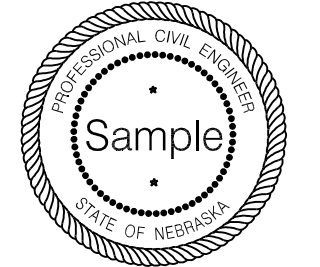

USER: sjemaso DATE: Wednesday, March 17, 2004 DGN: ...DESIGN(SHEETS)123456.DGN 123-4-56