



# SOUTH HAYMARKET PARK SKATEPARK

OPEN HOUSE #2 // MAY 7, 2024

**OPEN**

**HOUSE #1**

**SUMMARY**

## What are your wheels of choice?

Skateboard	44%
BMX Bike	7%
Skates (inline, roller, etc.)	14%
Scooter	2%
Wheelchair	0%
None of the above, just an interested	33%

### Response options

**Skateboard**

BMX Bike

Skates (inline, roller, etc.)

Scooter

Wheelchair

None of the above, just an interested community member

Count Percentage

**70 44%**

11 7%

23 14%

3 2%

0 0%

53 33%



Engagement

**160**

Responses

## How would you rate your skill level?

Response options	Count	Percentage
<b>Beginner</b>	<b>70</b>	<b>46%</b>
Intermediate	65	43%
Advanced	17	11%



Engagement

152

Responses

**What is your preferred ratio of street to transition terrain? (street = linear elements like steps, walls, rails, etc. | transition = curvilinear elements like ramps, bowls, etc.)**

Response options	Count	Percentage
100% street   0% transition	12	9%
70% street   30% transition	37	27%
<b>50% street   50% transition</b>	<b>59</b>	<b>43%</b>
30% street   70% transition	23	17%
0% street   100% transition	6	4%

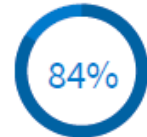

Engagement

137

Responses



BANKS



LEDGES / PADS



RAILS



TRANSITION

- **COMPETITION-LEVEL BOWL**
- **BEGINNER-FRIENDLY BOWL**
- **STAIRS**
- **SLAPPY CURB**
- **LONG LEDGES / MANUAL PADS**
- **PUMP TRACK**
- **SITE AMENITIES**
  - **LIGHTING**
  - **SPECTATOR SEATING**
  - **SHADE**
  - **DRINKING FOUNTAIN**

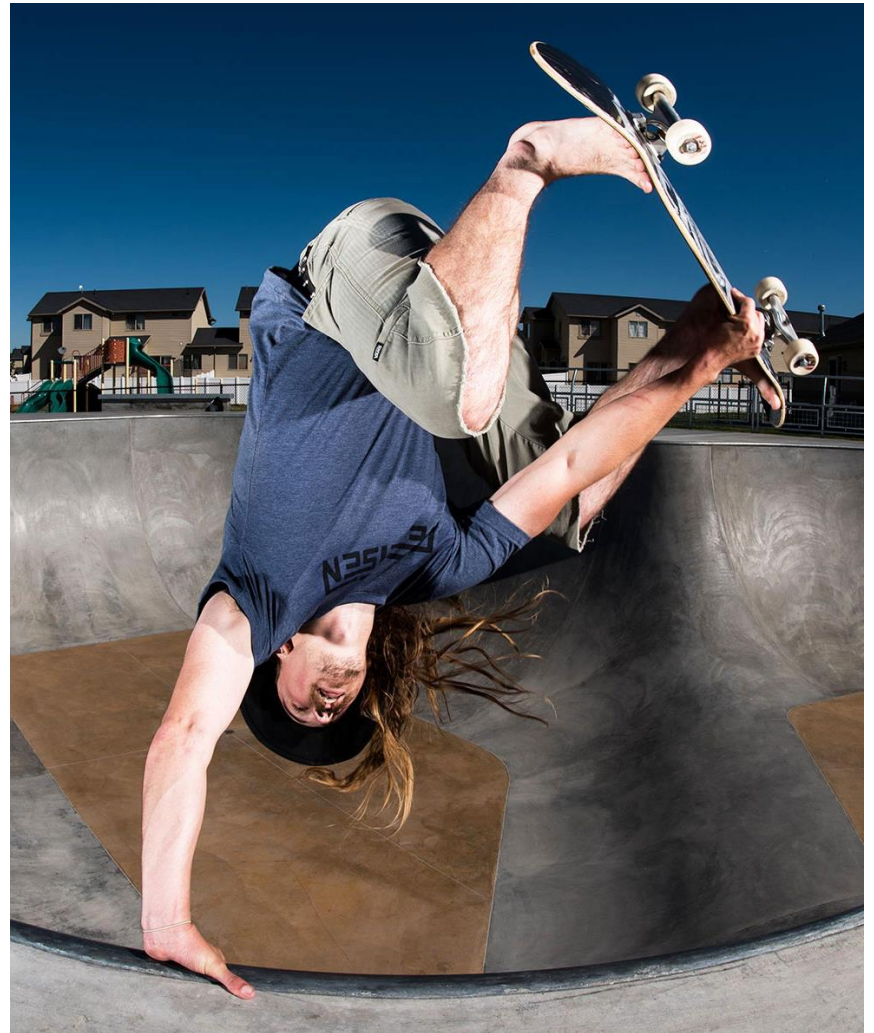

**CONCEPT**

**DESIGN**

SOUTH HAYMARKET PARK  
SKATEPARK























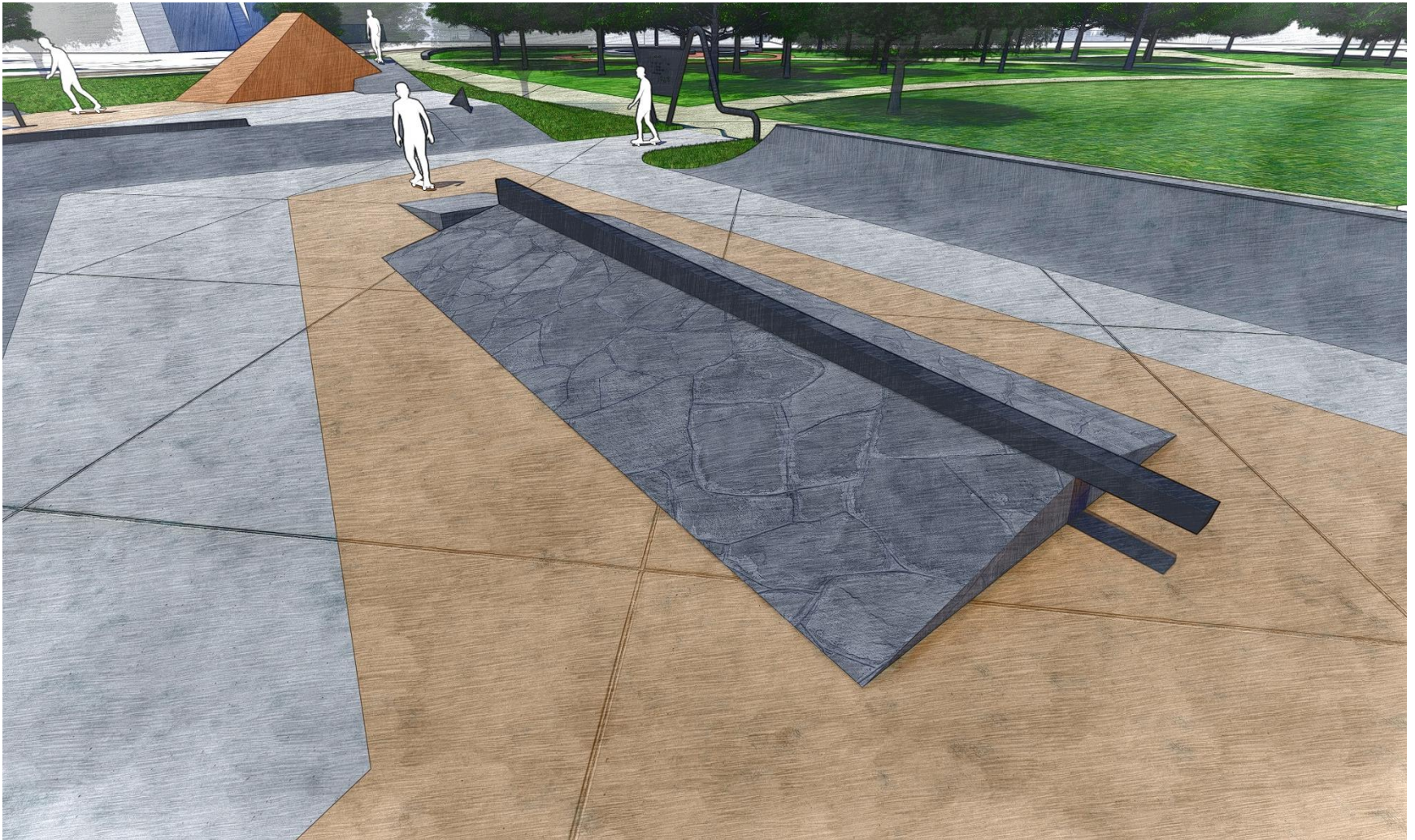

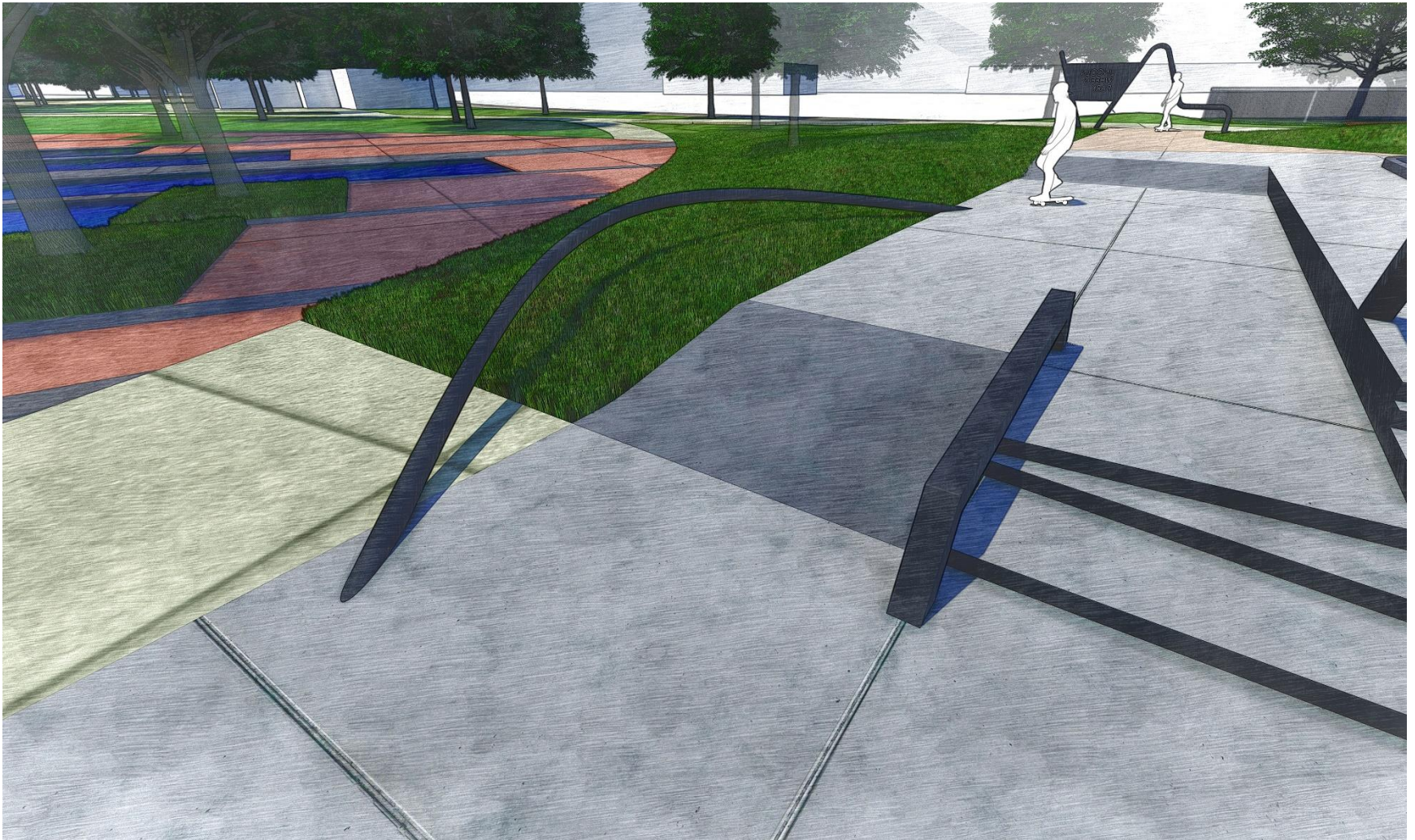

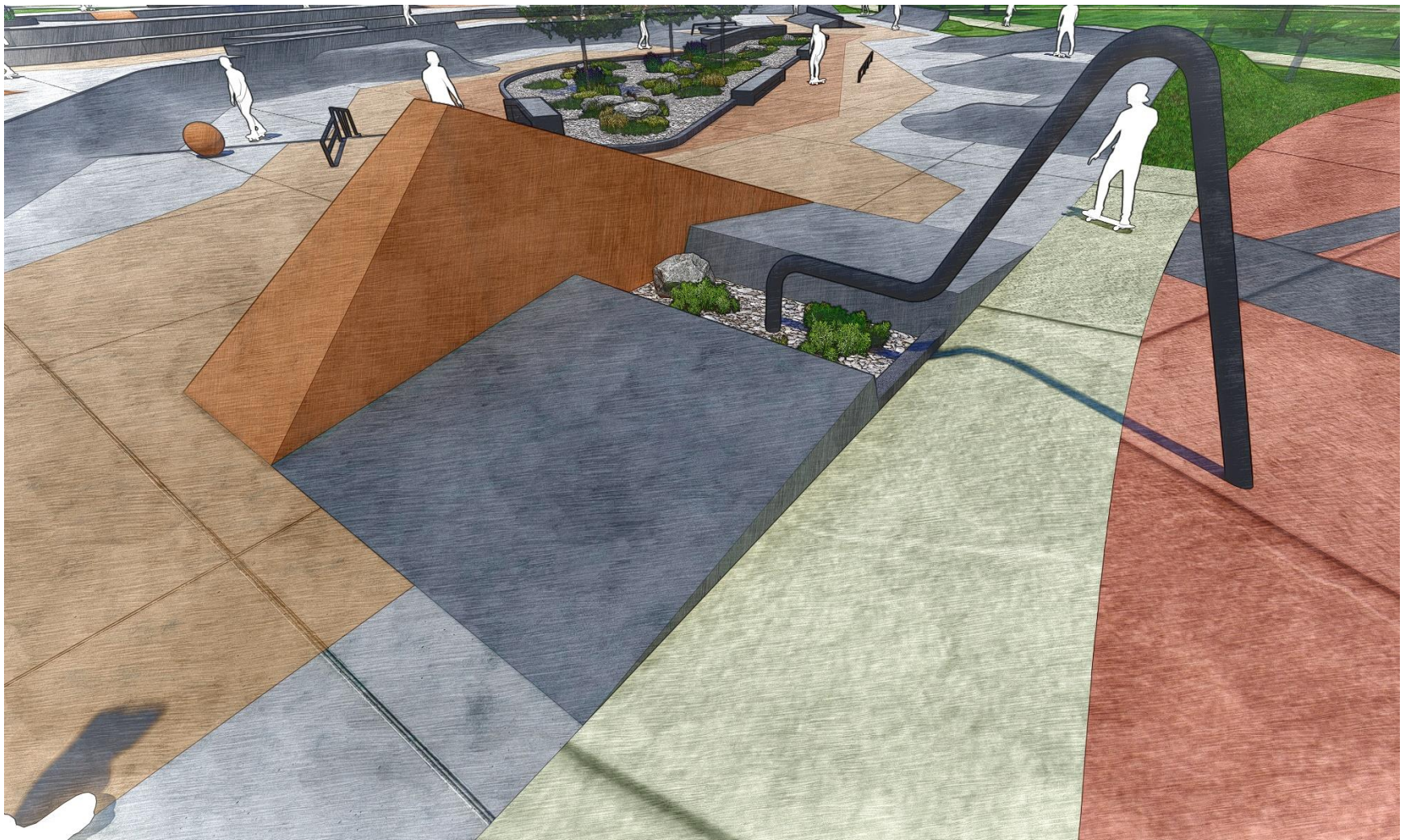

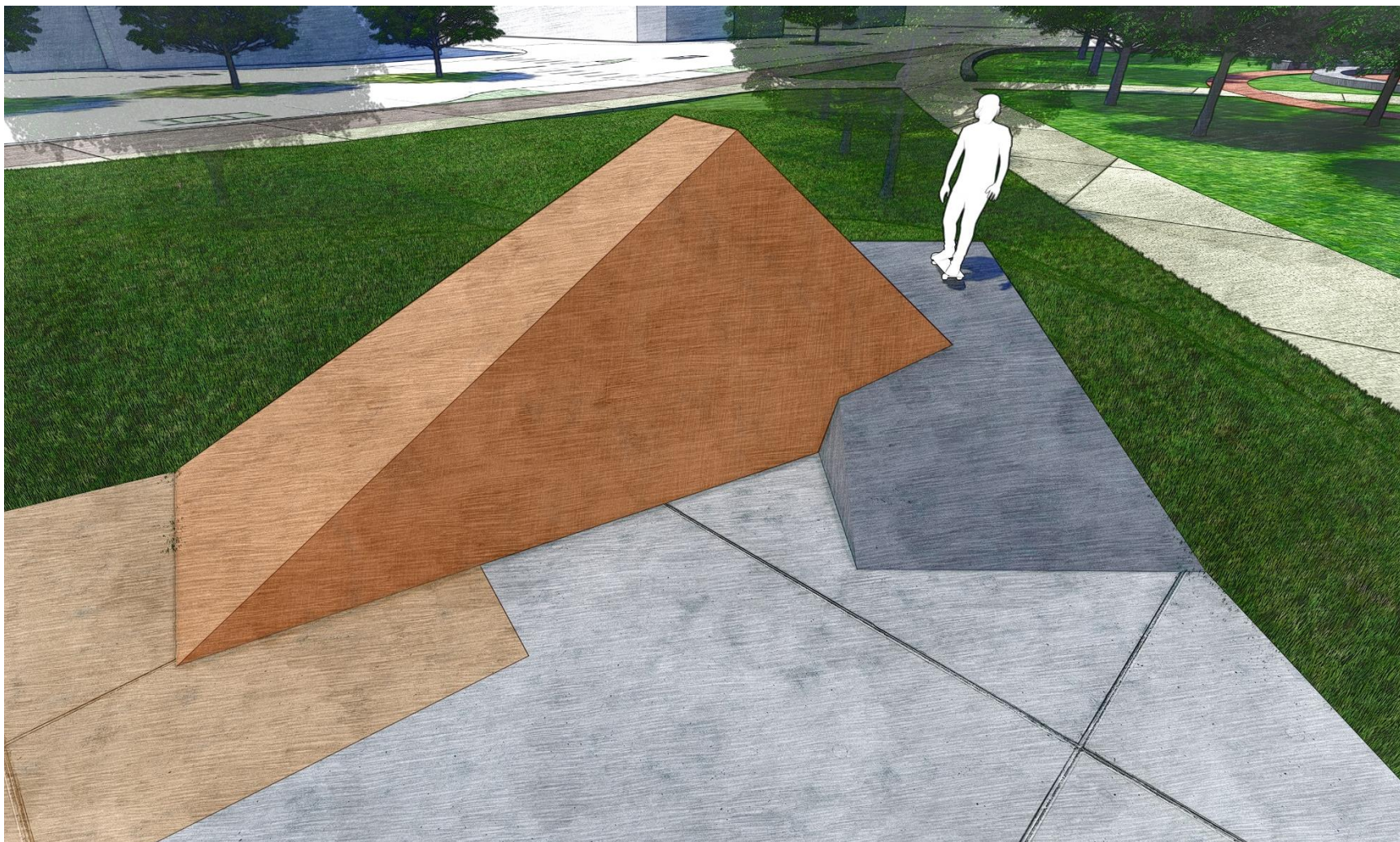





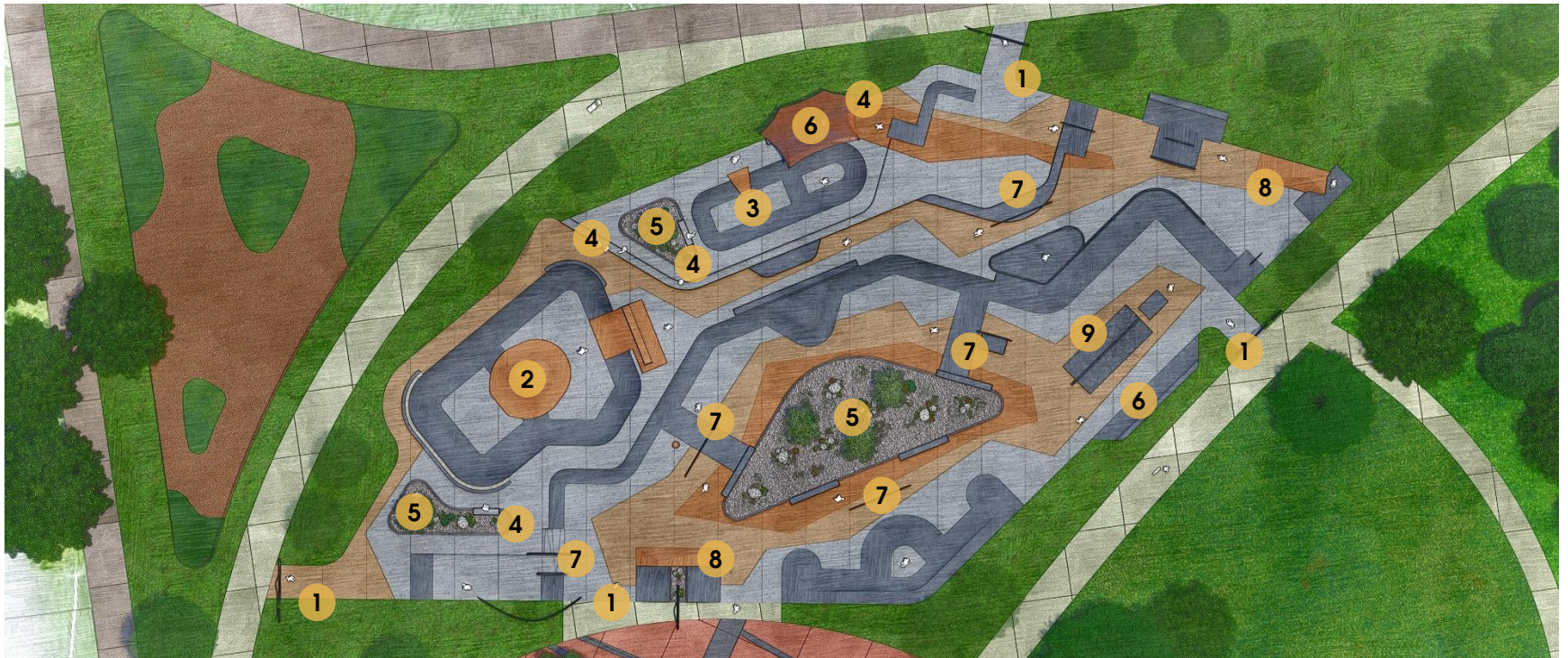

**ELEMENT LEGEND**

- |                  |                           |                       |
|------------------|---------------------------|-----------------------|
| 1. ACCESS POINT  | 4. SPECTATOR SEATING      | 7. STREET ELEMENTS    |
| 2. ADVANCED BOWL | 5. INTEGRATED LANDSCAPING | 8. VERTICAL SCULPTURE |
| 3. BEGINNER BOWL | 6. SHADE STRUCTURE        | 9. STAMPED CONCRETE   |



## PUMP TRACK

- 9 Pump Track Entry
- 10 Pump Feature
- 11 Central Landscape Feature
- 12 Existing Swale
- 13 Park Trail
- 14 Randy Gibson Trailhead
- 15 Walking Loop



**PUBLIC**

**INPUT**

CONCEPT DESIGN  
ALTERNATIVES













**ORIGINAL DESIGN**



**ALTERNATE DESIGN**



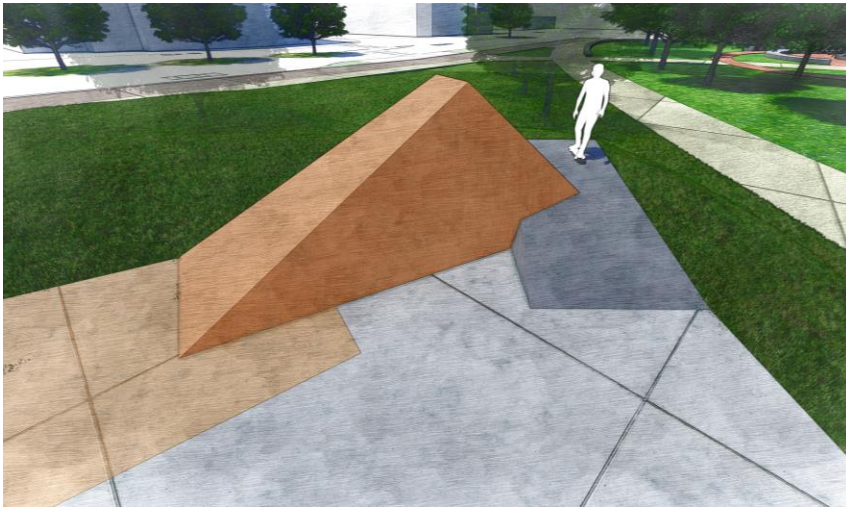

**ORIGINAL DESIGN**



**ALTERNATE DESIGN**

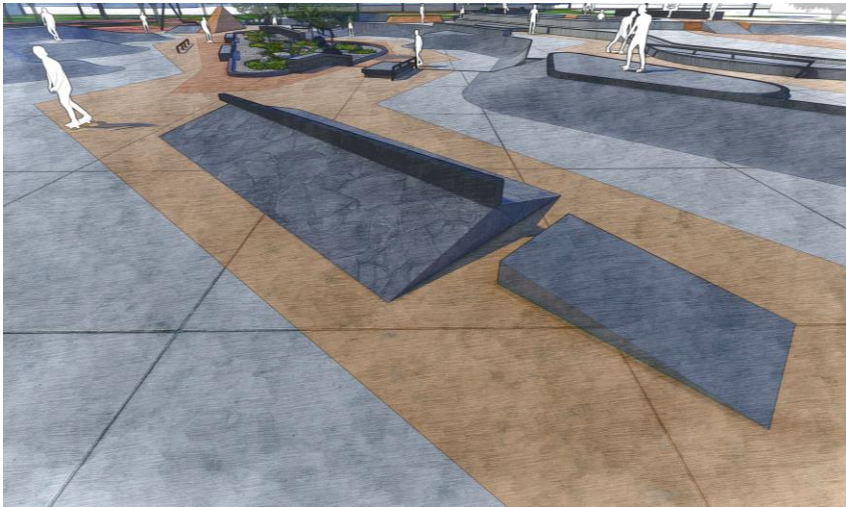

**ORIGINAL DESIGN**



**ALTERNATE DESIGN**



**ORIGINAL DESIGN**



**ALTERNATE DESIGN**

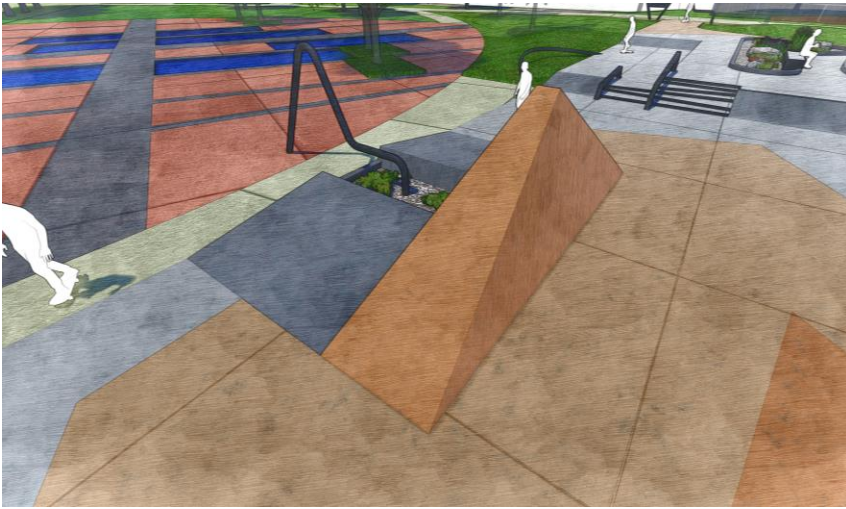

**ORIGINAL DESIGN**

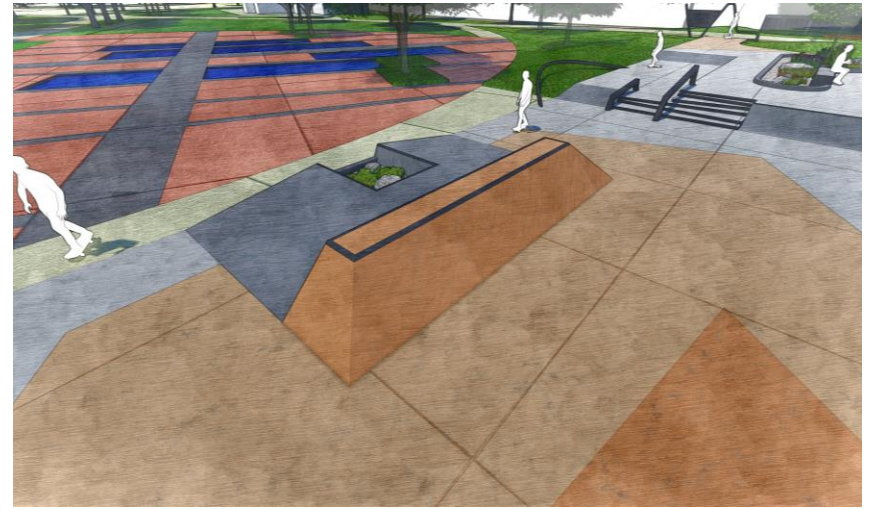

**ALTERNATE DESIGN**